



LUMINAIRE TESTING LABORATORY, INC.

SUSTAINING MEMBER of the IESNA

905 Harrison Street · Allentown, PA 18103 · 610-770-1044 · Fax 610-770-8912 · www.LuminaireTesting.com

LTL NUMBER: 11450

DATE: 05-01-2007

PREPARED FOR: CORONET, INC.

CATALOG NUMBER: HE-1

LUMINAIRE: FORMED WHITE ENAMEL STEEL HOUSING WITH PERFORATED SECTIONS, FORMED WHITE ENAMEL STEEL REFLECTOR WITH 2, 13" X 3-1/2" OPENINGS AND 8 CELL, 1-1/2" DEEP, FORMED WHITE ENAMEL STEEL LOUVERS WITH PERFORATED WHITE ENAMEL STEEL CROSS PIECES IN EACH OPENING, OPEN TOP.

LAMPS: FOUR 32 WATT T8 LINEAR FLUORESCENT LAMPS RATED AT 2850 LUMENS EACH.

LAMP CATALOG NUMBER: PHILIPS F32T8/TL850PLUS/ALTO

BALLAST: ONE ADVANCE REL-4P32-SC

MOUNTING: PENDANT

LUMEN TO CANDELA RATIO USED = 9.18

TOTAL INPUT WATTS = 112.4 AT 120.0 VOLTS

THE 0 DEGREE PLANE IS PARALLEL WITH THE LAMPS.

#11450

CANDELA DISTRIBUTION

	0.0	22.5	45.0	67.5	90.0
0	622	622	622	622	622
5	614	609	614	621	619
15	546	558	589	595	603
25	463	485	521	599	642
35	373	384	470	570	645
45	265	296	403	557	629
55	180	216	311	410	467
65	106	136	210	251	262
75	53	65	114	148	154
85	19	21	60	100	117
90	5	49	111	155	164
95	106	204	268	307	329
105	484	657	763	805	819
115	881	1037	1225	1300	1326
125	1243	1367	1576	1690	1726
135	1559	1660	1803	1948	1994
145	1823	1883	1988	2062	2093
155	2028	2059	2122	2165	2180
165	2157	2161	2200	2215	2219
175	2215	2214	2218	2212	2210
180	2220	2220	2220	2220	2220

FLUX

59
164
247
303
327
281
192
114
77
279
756
1154
1367
1386
1238
974
620
212

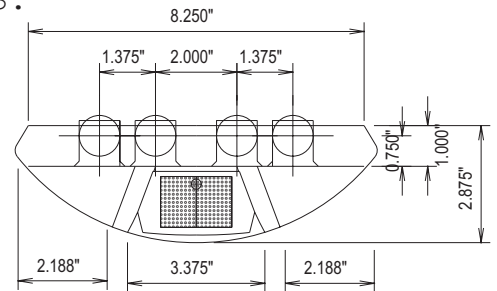

ZONAL LUMEN SUMMARY

ZONE	LUMENS	%LAMP	%FIXT
0- 30	470	4.0	4.8
0- 40	773	6.6	7.9
0- 60	1381	11.7	14.2
0- 90	1764	14.9	18.1
90-120	2189	18.5	22.5
90-130	3555	30.1	36.5
90-150	6179	52.4	63.4
90-180	7983	67.7	81.9
0-180	9747	82.6	100.0

TOTAL LUMINAIRE EFFICIENCY: 82.6%
TOTAL REFLECTANCE OF PAINT: 86.0%
CIE TYPE: SEMI-INDIRECT
PLANE: 0-DEG 90-DEG
SPACING CRITERIA: 1.0 1.6

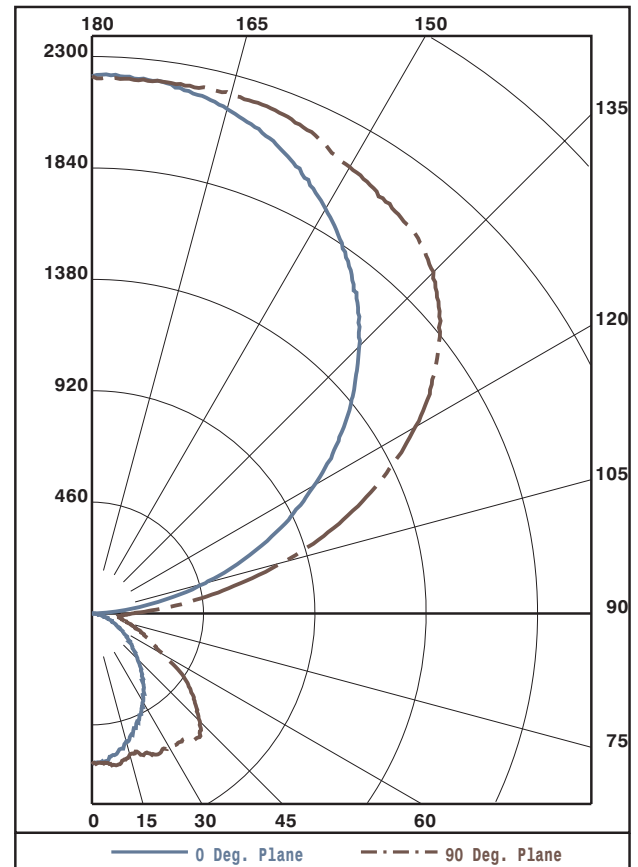

Approved By: MG



LUMINAIRE TESTING LABORATORY, INC.

SUSTAINING MEMBER of the IESNA

905 Harrison Street · Allentown, PA 18103 · 610-770-1044 · Fax 610-770-8912 · www.LuminaireTesting.com

LTL NUMBER: 11450
PREPARED FOR: CORONET, INC.

DATE: 05-01-2007

COEFFICIENTS OF UTILIZATION - ZONAL CAVITY METHOD
EFFECTIVE FLOOR CAVITY REFLECTANCE 0.20

Table with columns RC, RW, and rows for angles 0-10 degrees and reflectance values 80, 70, 50, 30, 10, 0.

PLANE: 0-DEG 90-DEG
LUMINOUS LENGTH: 44.000 8.750
HEIGHT OF SIDE: 0.000 1.375

Table with columns ANGLE IN DEG, AVERAGE 0-DEG, AVERAGE 45-DEG, AVERAGE 90-DEG.



LUMINAIRE TESTING LABORATORY, INC.

SUSTAINING MEMBER of the IESNA

905 Harrison Street · Allentown, PA 18103 · 610-770-1044 · Fax 610-770-8912 · www.LuminaireTesting.com

LTL NUMBER: 11450
PREPARED FOR: CORONET, INC.

DATE: 05-01-2007

CANDELA DISTRIBUTION

ZONAL LUMEN SUMMARY

Table with 6 columns for Candela Distribution (0.0, 22.5, 45.0, 67.5, 90.0) and 8 rows for Zonal Lumen Summary (0-5, 5-10, 10-15, 15-20, 20-25, 25-30, 30-35, 35-40, 40-45, 45-50, 50-55, 55-60, 60-65, 65-70, 70-75, 75-80, 80-85, 85-90, 90-95, 95-100, 100-105, 105-110, 110-115, 115-120, 120-125, 125-130, 130-135, 135-140, 140-145, 145-150, 150-155, 155-160, 160-165, 165-170, 170-175, 175-180).

THIS TEST WAS CONDUCTED USING RELATIVE PHOTOMETRY TECHNIQUES ACCORDING TO STANDARD IESNA PROCEDURES. THE USER MUST THEREFORE USE CAUTION IN THE FOLLOWING SITUATIONS: 1) THIS TEST WAS PERFORMED USING A SPECIFIC BALLAST/LAMP COMBINATION. EXTRAPOLATION OF THESE DATA FOR OTHER BALLAST/LAMP COMBINATIONS MAY PRODUCE ERRONEOUS RESULTS. 2) ACCORDING TO IESNA PROCEDURES, THE BALLAST(S) AND LAMP(S) ARE PRESUMED TO PRODUCE 100% OF RATED OUTPUT. AN APPROPRIATE BALLAST FACTOR MUST BE APPLIED TO THE LUMEN OUTPUT RATINGS AND LUMINOUS INTENSITY VALUES GIVEN. 3) THIS TEST WAS CONDUCTED IN A CONTROLLED LABORATORY ENVIRONMENT WHERE THE AMBIENT TEMPERATURE WAS HELD AT 25°C ±1°C. FIELD PERFORMANCE MAY DIFFER PARTICULARLY IN REGARDS TO CHANGE IN LUMINOUS OUTPUT AS A RESULT OF DIFFERENCE IN AMBIENT TEMPERATURE AND METHOD OF MOUNTING THE LUMINAIRE.